

# MEGA

 **M. J. MAILLIS GROUP**

*STRAPPING MACHINES AND PACKAGING TECHNOLOGIES*



**MEGA S.r.l. - Viale Industria 140 - 27025 - Gambolò (PV) - Italy**  
**Tel. +39 0381 930315 - Fax. +39 0381 939215**  
**E-Mail: [megasrl@tin.it](mailto:megasrl@tin.it) - Web: [www.megasrl.com](http://www.megasrl.com)**

## VERTICAL STRAPPING MACHINE VR/4-1TL

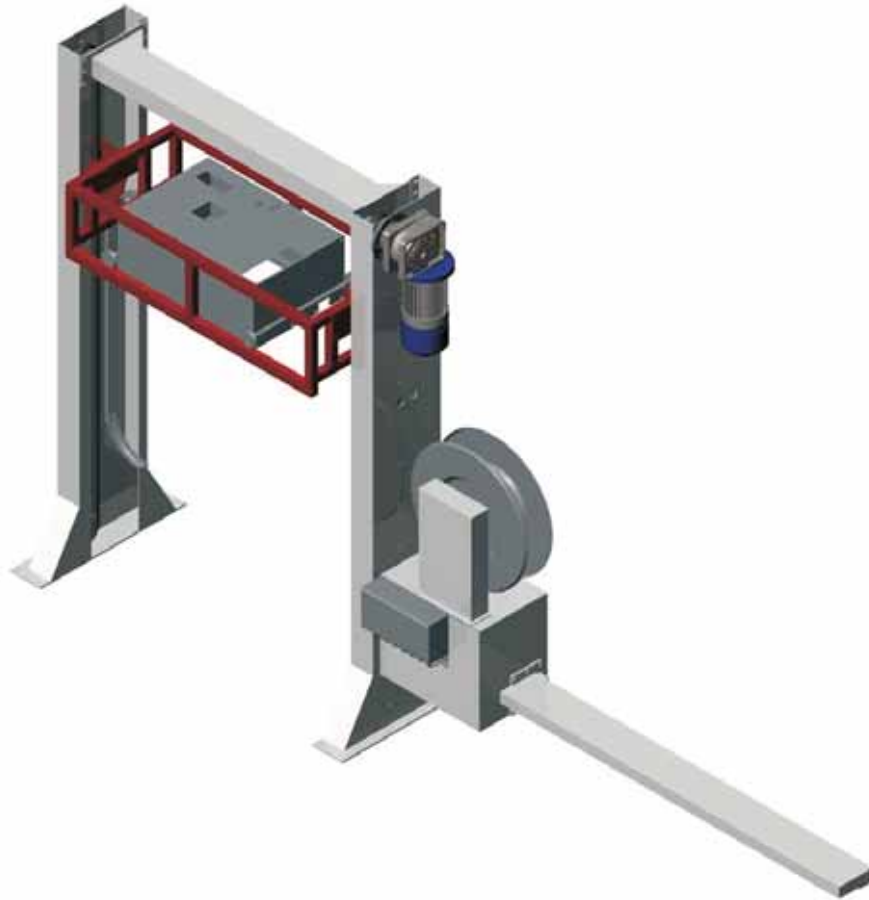

The VR/4 1TL is a machine appositely planned to have a complete automation of packaging lines.

The machine makes the vertical strap of palletized units with different Heights, thanks to the strapping head that get on the top of pallet through a device that provides even the strapping cycle in the same time.

The strap tensioning happens through a special dynamometric device that guarantees the best exploitation of the strap elasticity.

The Electric Control Panel and the Keyboard Operator are both with an elevate protection IP degree: all connections are clearly identified and numbered according to the CEI rules. The apparatus is realized for an alternatively manual and automatic function: all main functions are signalled by light signals; the setting of the automatic programm denies any manual accidental intervention.

### Technical Details

Useful Strap Dimensions	Polyester, Polypropylene
Function	12/16mm, 0.7/1 mm. thickness
Strap Tension	Electromechanic, pneumatic
Throwing Speed	50 3500 N
Up/Down Head speed	3mt/sec. adjustable with inverter
Cutting/Welding cycle	0.25mt/sec
Installed Power	2.2 sec
	5Kw

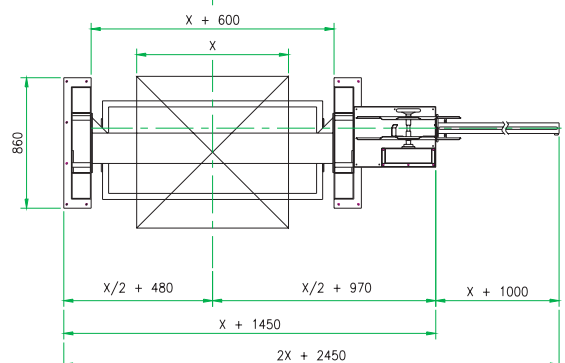
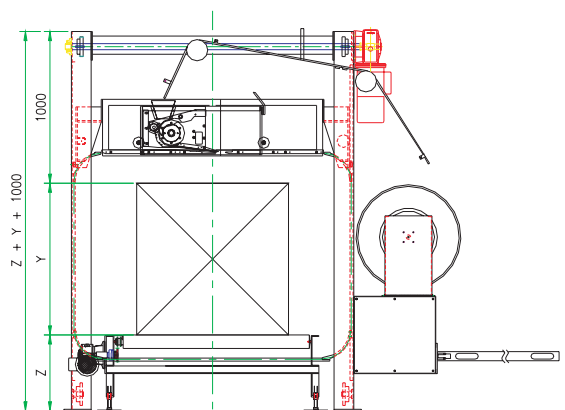

## VERTICAL STRAPPING MACHINE VR/4-1T

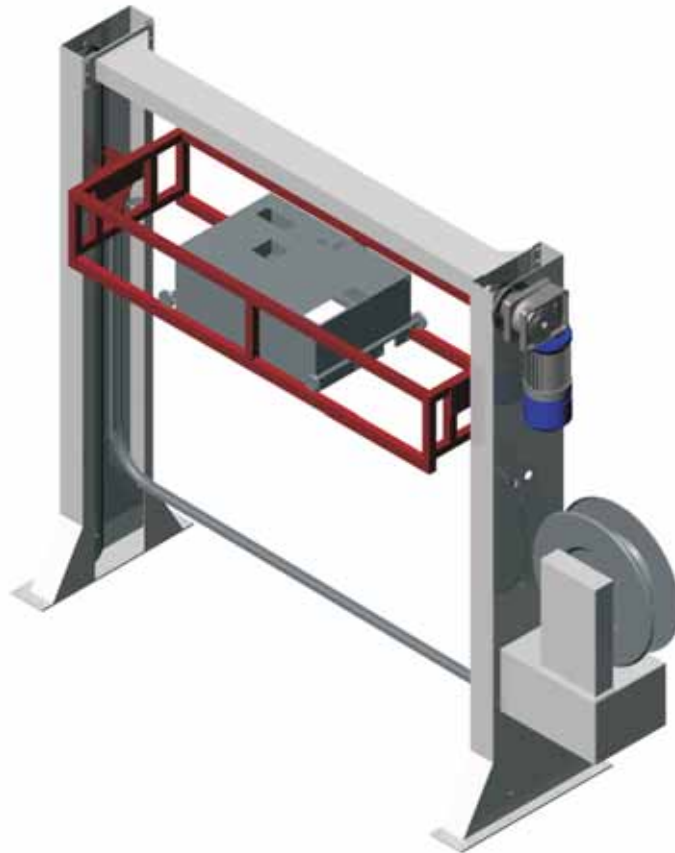

The VR/4 1T is a machine appositively planned to have a complete automation of packaging lines.

The machine makes the vertical strap of non palletized units with different Heights, thanks to the strapping head that get on the top of pallet throught a device that provides even the strapping cycle in the same time.

The strap tensoning happens through a special dinamometric device that guarantees the best exploitation of the strap elasticity.

The machine can be fitted on every type of conveying system, between two conveyors.

The Electric Control Panel and the Keyboard Operator are both with an elevate protection IP degree: all connections are clearly identified and numbered according to the CEI rules. The apparatus is realized for an alternatively manual and automatic function: all main functions are signalled by light signals; the setting of the automatic programm denies any manual accidental intervention.

### Technical Details

Useful Strap	Polyester, Polypropylene
Dimensions	12/16mm, 0.7/1 mm. thickness
Function	Electromechanic, pneumatic
Strap Tension	50 3500 N
Throwing Speed	3mt/sec. adjustable with inverter
Up/Down Head speed	0.25mt/sec
Cutting/Welding cycle	2.2 sec
Installed Power	5Kw

